



WOOLPERT

# Warren County GIS GPS Control Network

## Control Monument Information Sheet



<i>Township</i> UNION	<i>Station Description</i> The station is located southeast of the intersection of Shawhan Road and Stubbs Mills Road. The station is a concrete monument with an aluminium disk, set +/- 0.2ft. below grade and is stamped WARREN CO. GIS, GPS 7, 1995.			<i>Station Designation</i> 7
<i>Locality/County</i> WARREN				<i>Stamping on Mark</i> WARREN CO. GIS GPS 7, 1995
<i>Date, Set or Found</i> JUNE 1995 SET	<i>Latitude</i> N39° 23'15.03204"	<i>Longitude</i> W84° 10'0.77285"	<i>Horizontal Datum</i> NAD 83	<i>State Plane Zone</i> OHS3402
	<i>Northing</i> 509700.985 (US survey ft.)	<i>Easting</i> 1497412.871 (US survey ft.)	<i>Elevation</i> 888.368 (US survey ft.)	<i>Vertical Datum</i> NAVD 88
<i>Crew Chief</i> T. MOCHTY	<i>Convergence</i> -1° 3'27.607609"	<i>Back Station I.D.</i>	<i>Grid Azimuth &amp; Distance to back station</i>	
<i>Established by Agency</i> WOOLPERT	<i>Scale Factor</i> .99993590	<i>Ahead Station I.D.</i> 7A	<i>Grid Azimuth &amp; Distance to ahead station</i> 331° 46'2.745" 1170.3(feet)	

Ohio Professional Surveyor  
charge of monumentation

THOMAS F. MOCHTY

Oh. Registration No.

\*7682



No Scale

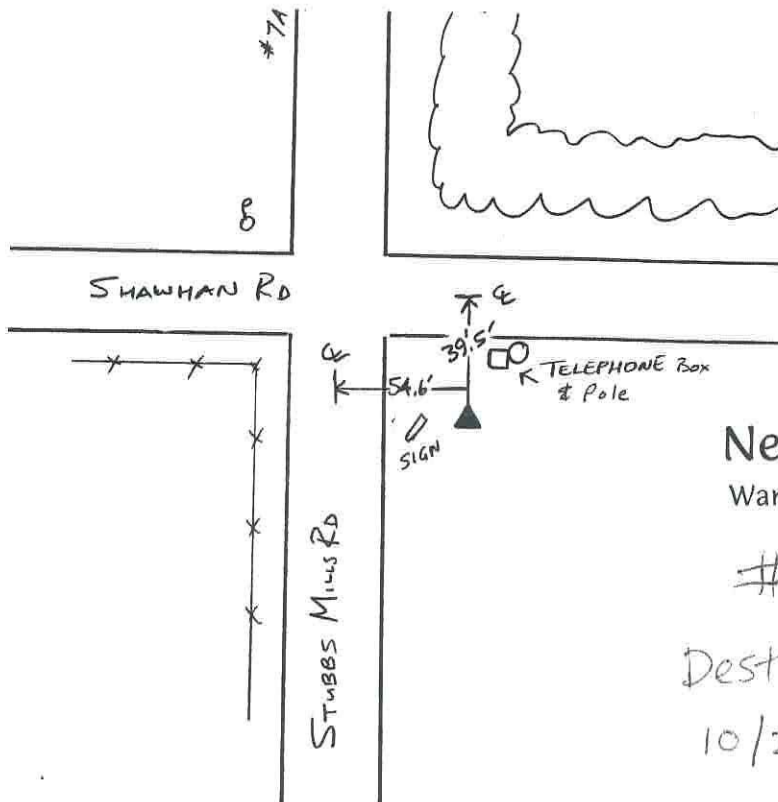

Neil F. Tunison  
Warren County Engineer

#7

Destroyed/Removed

10/24/02

V.T.



WOOLPERT

# Warren County GIS GPS Control Network

## Control Monument Information Sheet



<i>Township</i> UNION	<i>Station Description</i> The station is located 0.15 mi. north of the intersection of Shawhan Road and Stubbs Mills Road and is on the west side of Stubbs Mills Road. The station is a concrete monument with an aluminium disk, set +/- 0.2ft. below grade and is stamped WARREN CO. GIS, GPS 7A, 1995.			<i>Station Designation</i> 7A
<i>Locality/County</i> WARREN				<i>Stamping on Mark</i> WARREN CO. GIS GPS 7A, 1995
<i>Date, Set or Found</i> JUNE 1995 SET	<i>Latitude</i> N39° 23'25"	<i>Longitude</i> W84° 10'8"	<i>Horizontal Datum</i> NAD 83	<i>State Plane Zone</i> OHS3402
	<i>Northing</i> (US survey ft.)	<i>Easting</i> (US survey ft.)	<i>Elevation</i> (US survey ft.)	<i>Vertical Datum</i> NAVD 88
<i>Crew Chief</i> T. MOCHTY	<i>Convergence</i>	<i>Back Station I.D.</i> 7	<i>Grid Azimuth &amp; Distance to back station</i> 151° 46'2.754" 1170.3(feet)	
<i>Established by Agency</i> WOOLPERT	<i>Scale Factor</i>	<i>Ahead Station I.D.</i>	<i>Grid Azimuth &amp; Distance to ahead station</i>	

Ohio Professional Surveyor  
in charge of monumentation

THOMAS F. MOCHTY

Oh. Registration No.

#7682

