



WOOLPERT

# Warren County GIS GPS Control Network



## Control Monument Information Sheet

<i>Township</i> SALEM	<i>Station Description</i> The station is located .22 mi. south of the intersection of Bennett Road and Morrow-Rossburg Road and is on the east side of Morrow-Rossburg Road. The station is a concrete monument with an aluminium disk, set +/- 0.2ft. below grade and is stamped WARREN CO. GIS, GPS 69, 1995.			<i>Station Designation</i> 69
<i>Locality/County</i> WARREN				<i>Stamping on Mark</i> WARREN CO. GIS GPS 69, 1995
<i>Date, Set or Found</i> JUNE 1995 SET	<i>Latitude</i> N39° 20' 23.33880"	<i>Longitude</i> W84° 08' 11.89094"	<i>Horizontal Datum</i> NAD 83	<i>State Plane Zone</i> OHS3402
	<i>Northing</i> 492176.762 (US survey ft.)	<i>Easting</i> 1505644.810 (US survey ft.)	<i>Elevation</i> 780.527 (US survey ft.)	<i>Vertical Datum</i> NAVD 88
<i>Crew Chief</i> T. MOCHTY	<i>Convergence</i> -1° 2' 18.519910"	<i>Back Station I.D.</i>	<i>Grid Azimuth &amp; Distance to back station</i>	
<i>Established by Agency</i> WOOLPERT	<i>Scale Factor</i> .99993620	<i>Ahead Station I.D.</i> 69A	<i>Grid Azimuth &amp; Distance to ahead station</i> 188° 21' 26.781" 993.6(feet)	

Ohio Professional Surveyor  
charge of monumentation

THOMAS F. MOCHTY

Oh. Registration No.

•7682

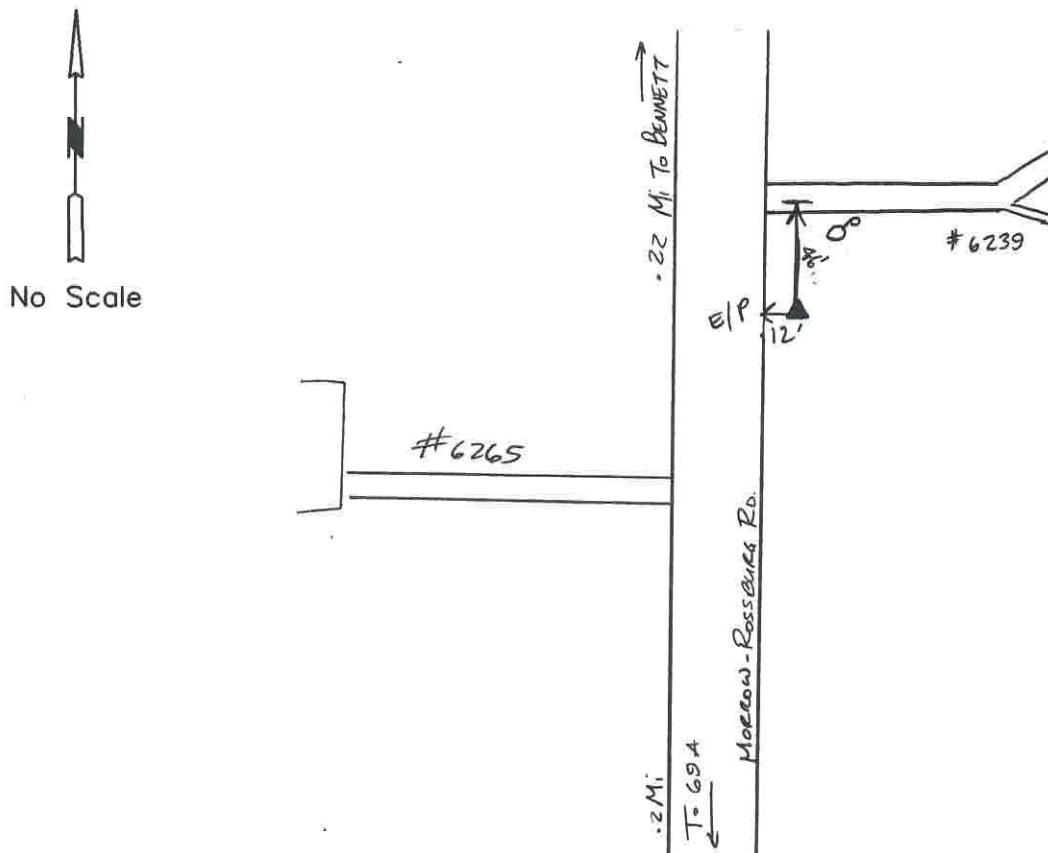



WOOLPERT

# Warren County GIS GPS Control Network

## Control Monument Information Sheet



<i>Township</i> SALEM	<i>Station Description</i> The station is located 0.42 mi. south of the intersection of Bennett Road and Morrow-Rossburg Road and is on the west side of Morrow-Rossburg Road. The station is a concrete monument with an aluminium disk, set +/- 0.2ft. below grade and is stamped WARREN CO. GIS, GPS 69A, 1995.			<i>Station Designation</i> 69A
<i>Locality/County</i> WARREN				<i>Stamping on Mark</i> WARREN CO. GIS GPS 69A, 1995
<i>Date, Set or Found</i> JUNE 1995 SET	<i>Latitude</i> N39° 20'13"	<i>Longitude</i> W84° 08'13"	<i>Horizontal Datum</i> NAD 83	<i>State Plane Zone</i> OHS3402
	<i>Northing</i> (US survey ft.)	<i>Easting</i> (US survey ft.)	<i>Elevation</i> (US survey ft.)	<i>Vertical Datum</i> NAVD 88
<i>Crew Chief</i> T. MOCHTY	<i>Convergence</i>	<i>Back Station I.D.</i> 69	<i>Grid Azimuth &amp; Distance to back station</i> 8° 21'26.781" 993.6(feet)	
<i>Established by Agency</i> WOOLPERT	<i>Scale Factor</i>	<i>Ahead Station I.D.</i>	<i>Grid Azimuth &amp; Distance to ahead station</i>	

Ohio Professional Surveyor  
charge of monumentation

THOMAS F. MOCHTY

Oh. Registration No.  
\*7682



No Scale

