



WOOLPERT

Warren County GIS GPS Control Network

Control Monument Information Sheet



<i>Township</i> WAYNE	<i>Station Description</i> The station is located on the west side of Lytle-Ferry Road and is across from #8692. The station is a concrete monument with an aluminium disk, set +/- 0.2ft. below grade and is stamped WARREN CO. GIS, GPS 268, 1995.			<i>Station Designation</i> 268
<i>Locality/County</i> WARREN				<i>Stamping on Mark</i> WARREN CO. GIS GPS 268, 1995
<i>Date, Set or Found</i> JUNE 1995 SET	<i>Latitude</i> N39° 33'38.04705"	<i>Longitude</i> W84° 05'39.44779"	<i>Horizontal Datum</i> NAD 83	<i>State Plane Zone</i> OHS3402
	<i>Northing</i> 572354.288 (US survey ft.)	<i>Easting</i> 1519038.717 (US survey ft.)	<i>Elevation</i> 1007.360 (US survey ft.)	<i>Vertical Datum</i> NAVD 88
<i>Crew Chief</i> T. MOCHTY	<i>Convergence</i> -1° 0'41.791753"	<i>Back Station I.D.</i>	<i>Grid Azimuth & Distance to back station</i>	
<i>Established by Agency</i> WOOLPERT	<i>Scale Factor</i> .99994060	<i>Ahead Station I.D.</i> 268A	<i>Grid Azimuth & Distance to ahead station</i> 344° 50'7.473" 723.8(feet)	

Ohio Professional Surveyor
in charge of monumentation

THOMAS F. MOCHTY

Oh. Registration No.
#7682

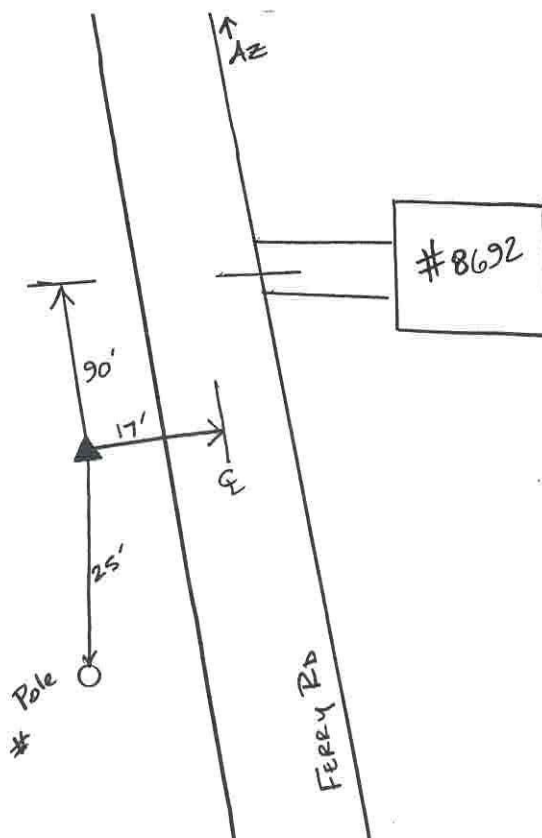

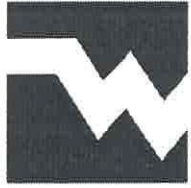

WOOLPERT

Warren County GIS GPS Control Network



Control Monument Information Sheet

<i>Township</i> WAYNE	<i>Station Description</i> The station is located 0.1 mi. south of the intersection of Haines Road and Ferry Road and is on the northeast side of Ferry Road. The station is a concrete monument with an aluminium disk, set +/- 0.2ft. below grade and is stamped WARREN CO. GIS, GPS 268A, 1995.			<i>Station Designation</i> 268A
<i>Locality/County</i> WARREN				<i>Stamping on Mark</i> WARREN CO. GIS GPS 268A, 1995
<i>Date, Set or Found</i> JUNE 1995 SET	<i>Latitude</i> N39° 33'44"	<i>Longitude</i> W84° 05'42"	<i>Horizontal Datum</i> NAD 83	<i>State Plane Zone</i> OHS3402
	<i>Northing</i> (US survey ft.)	<i>Easting</i> (US survey ft.)	<i>Elevation</i> (US survey ft.)	<i>Vertical Datum</i> NAVD 88
<i>Crew Chief</i> T. MOCHTY	<i>Convergence</i>	<i>Back Station I.D.</i> 268	<i>Grid Azimuth & Distance to back station</i> 164° 50'7.473" 723.8(feet)	
<i>Established by Agency</i> WOOLPERT	<i>Scale Factor</i>	<i>Ahead Station I.D.</i>	<i>Grid Azimuth & Distance to ahead station</i>	

Ohio Professional Surveyor
in charge of monumentation

THOMAS F. MOCHTY

Oh. Registration No.
*7682



No Scale

