



WOOLPERT

# Warren County GIS GPS Control Network



## Control Monument Information Sheet

<i>Township</i> MASSIE	<i>Station Description</i> The station is located in the northeast corner of the intersection of Wilmington Road-Lebanon Road and Harveysburg Road-George Road. The station is a concrete monument with an aluminium disk, set +/- 0.2ft. below grade and is stamped WARREN CO. GIS, GPS 119, 1995.			<i>Station Designation</i> 119
<i>Locality/County</i> WARREN				<i>Stamping on Mark</i> WARREN CO. GIS GPS 119, 1995
<i>Date, Set or Found</i> JUNE 1995 SET	<i>Latitude</i> N39° 26'40.48551"	<i>Longitude</i> W83° 59'18.57760"	<i>Horizontal Datum</i> NAD 83	<i>State Plane Zone</i> OHS3402
	<i>Northing</i> 529603.833 (US survey ft.)	<i>Easting</i> 1548165.824 (US survey ft.)	<i>Elevation</i> 965.605 (US survey ft.)	<i>Vertical Datum</i> NAVD 88
<i>Crew Chief</i> T. MOCHTY	<i>Convergence</i> -0° 56'40.122177"	<i>Back Station I.D.</i>	<i>Grid Azimuth &amp; Distance to back station</i>	
<i>Established by Agency</i> WOOLPERT	<i>Scale Factor</i> .99993650	<i>Ahead Station I.D.</i> 119A	<i>Grid Azimuth &amp; Distance to ahead station</i> 156° 46'13.269" 1560.7(feet)	
<i>Ohio Professional Surveyor in charge of monumentation</i> THOMAS F. MOCHTY			<i>Oh. Registration No.</i> *7682	

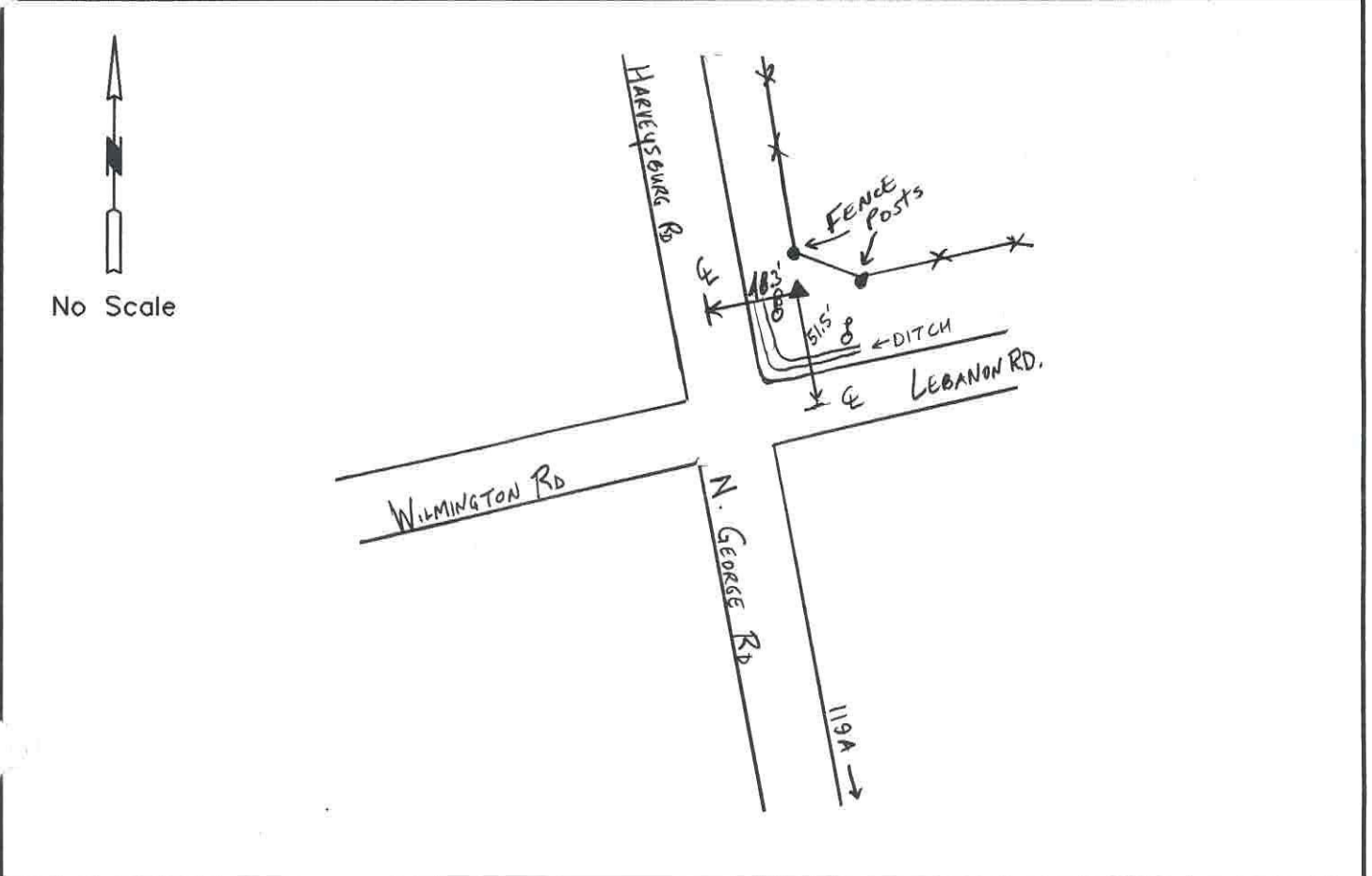



WOOLPERT

# Warren County GIS GPS Control Network



## Control Monument Information Sheet

<i>Township</i> MASSIE	<i>Station Description</i> The station is located 0.29 mi. south of the intersection of Wilmington-Lebanon Road and N. George Road and is on the west side of N. George Road. The station is a concrete monument with an aluminium disk, set +/- 0.2ft. below grade and is stamped WARREN CO. GIS, GPS 119A, 1995.			<i>Station Designation</i> 119A
<i>Locality/County</i> WARREN				<i>Stamping on Mark</i> WARREN CO. GIS GPS 119A, 1995
<i>Date, Set or Found</i> JUNE 1995 SET	<i>Latitude</i> N39° 26'26"	<i>Longitude</i> W83° 59'10"	<i>Horizontal Datum</i> NAD 83	<i>State Plane Zone</i> OHS3402
	<i>Northing</i> (US survey ft.)	<i>Easting</i> (US survey ft.)	<i>Elevation</i> (US survey ft.)	<i>Vertical Datum</i> NAVD 88
<i>Crew Chief</i> T. MOCHTY	<i>Convergence</i>	<i>Back Station I.D.</i> 119	<i>Grid Azimuth &amp; Distance to back station</i> 336° 46'13.269" 1560.7(feet)	
<i>Established by Agency</i> WOOLPERT	<i>Scale Factor</i>	<i>Ahead Station I.D.</i>	<i>Grid Azimuth &amp; Distance to ahead station</i>	

Ohio Professional Surveyor  
charge of monumentation

THOMAS F. MOCHTY

Oh. Registration No.  
#7682



No Scale

